

CVM-VM10

Micro Cardioid Condenser Shotgun Microphone

User Manual

Foreword

Thanks for purchasing COMICA CVM-VM10II Micro Cardioid Condenser Shotgun Microphone.

Main Features

- . Cardioid Pattern, Universal for Camera and Smartphone
- . No Power Drive, Convenient for Use
- . Full Metal Material Construction and Super Shielding
- . Professional Shock Mount
- . Packed with Windscreen and Wind Muff

Notice

- ⚠ When working with USB devices, it is necessary to purchase relevant audio adapter cable by yourself.
- ⚠ For the smartphone with Android system, the Mic works well in audio mode, it may not be compatible with most of the smartphones in video mode (Then we suggest you to try the 3rd party APP, such as Filmic Pro, Proshot, ect.).
- ⚠ For the smartphone with iOS system, the mic works well either in audio or video mode.

Packing List

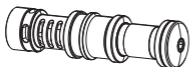

Microphone



Shock Mount



3.5mm TRS-TRS Audio Cable



3.5mm TRS-TRRS Audio Cable

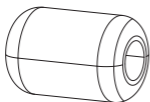

Windscreen

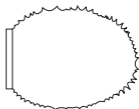

Wind Muff



Carry Case



User Manual



Warranty Card

Installation and Operation

Install the microphone on the shock mount as shown below

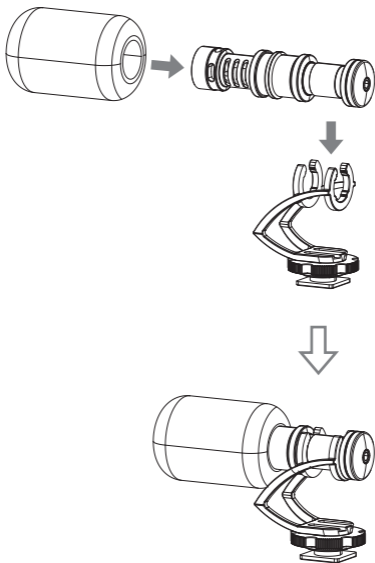

Work with camera:

Install the CVM-VM10II to the camera via cold shoe mount, then connect the CVM-VM10II and camera through 3.5mm TRS-TRS audio cable

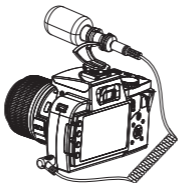

Work with smartphone:

Install the CVM-VM10II and smartphone to the smartphone holder, then connect the CVM-VM10II and smartphone through 3.5mm TRS-TRRS audio cable (Please purchase the smartphone holder by yourself)

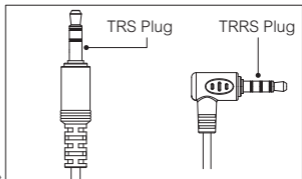
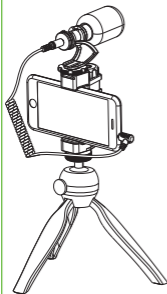

 Please pay attention to the TRS plug is for microphone and the TRRS plug is for smartphone

1. Frequency Response

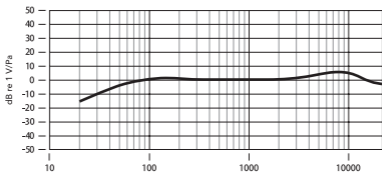

2. Polar Pattern

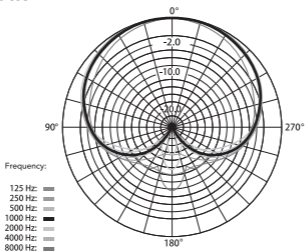

3. Technology Parameters

Polar Pattern	Cardioid
Frequency Range	60Hz~20kHz
Signal / Noise	>75dB
Maximum SPL	>105dB
Sensitivity	-33dB±2dB
Operation Voltage	1V~5V DC
Output Interface	3.5mm
Dimension	Φ21mm x 85mm
Weight	34.2g
Working Temperature	0~50℃

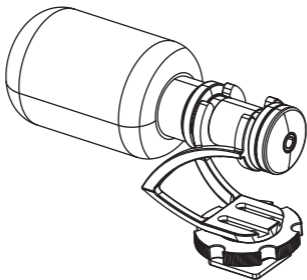

CVM-VM10 II

迷你心型指向电容枪式麦克风

使用说明书

前言

感谢您购买科唛CVM-VM10II迷你心型指向电容枪式麦克风。

产品主要功能

- 心型指向，适用于相机和手机
- 无电驱动，方便易用
- 全金属结构，超强屏蔽
- 专业减震支架
- 配备防风毛及防风棉

注意事项

- ⚠️ 搭配USB设备使用时，请自行配置相关音频转接线
- ⚠️ 配合Android（安卓）系统的手机使用时，录音模式下均可正常工作，视频模式下大多数手机会出现不兼容情况（此时建议使用第三方视频软件，如：抖音，快手等）
- ⚠️ 配合iOS系统手机使用时，在所有录音模式、视频模式以及第三方视频软件下均可正常使用

包装清单

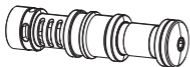

麦克风



减震架



3.5mm TRS-TRS音频连接线



3.5mm TRS-TRRS音频连接线

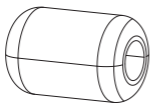

防风棉

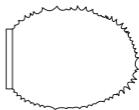

防风毛



便携包



说明书



保修卡

安装方法

如下图所示将麦克风安装到减震架上

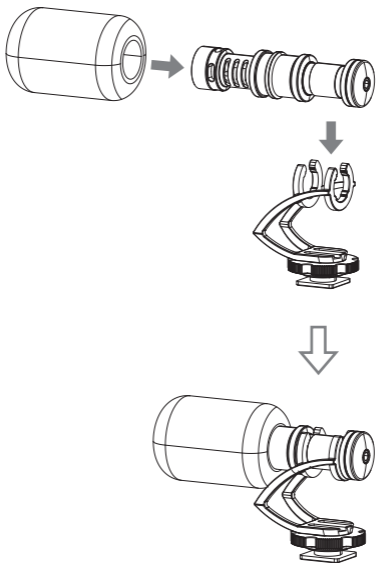

搭配相机使用：

通过冷靴座把CVM-VM10II安装到相机上，再通过3.5mm TRS-TRS音频连接线连接CVM-VM10II与相机



搭配手机使用：

把CVM-VM10II与手机安装到支架上，再通过3.5mm TRS-TRRS音频连接线连接CVM-VM10II与手机（支架请自行购买）

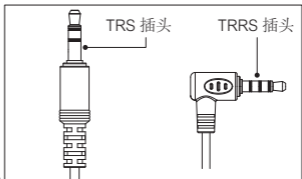
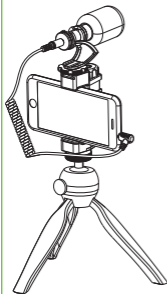

注意连接麦克风一端为TRS插头，连接手机一端为TRRS插头

1. 频率响应

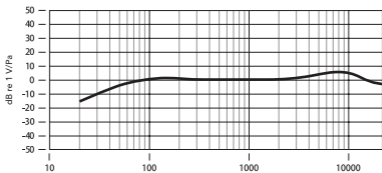

2. 指向性图

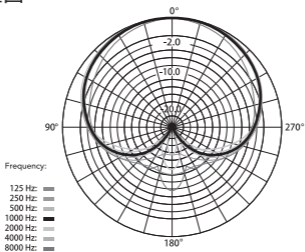

3. 性能参数

指向性	心型
频响	60Hz~20kHz
信噪比	>75dB
最大声压级	>105dB
灵敏度	-33dB±2dB
工作电压	1V~5V DC
输出接口	3.5mm
尺寸	Φ21mm x 85mm
净重	34.2g
工作温度	0~50℃



www.comica-audio.com