

# 7RYMS



## iRay DW20

2.4G Dual-channel Wireless Microphone

### User Manual



## Foreword

Thanks for purchasing 7RYMS iRay DW20

## Main Features

- . 2.4G Dual-channel Wireless Microphone, Global Free Frequency
- . 48kHz/16bit Audio Recording, Intelligent Denoise
- . Support Digital&Analog Output Mode, Universal for Phone, Computer and Camera
- . Mono/Stereo/Safety Mode for Ultimate Flexibility in Post-production
- . LCD Screen for Intuitive Power and Audio Dynamic Monitor
- . Preamp Amplifier and 10-level Adjusted Gain Control
- . Real-time Audio Monitor and Mute Function
- . Internal and External MIC Two Input Modes
- . Low Latency < 20ms, Working Range Up to 100m(Open Environment)
- . Designed with Multi-functional Belt Clip and Compact

## Notice

- △ Due to 2.4G wireless characteristics, it is better to keep face to face when use it, and do not turn your back to the receiver, otherwise it is easy to generate breakpoints, which is a normal phenomenon
- △ Do not block the antenna position to avoid any poor signal generated
- △ Please attention that it can not realize STEREO function when in single-channel and safety mode
- △ The product belongs to high-precision instruments, please avoid falling, collision or pounding
- △ Do not use the equipment in the vicinity of heat source or interference source, such as radiator, oven, intercom or next to the other wireless devices
- △ If the pick-up distance is close or when it is used outdoors, please put on the wind muff to prevent sound burst or reduce wind noise
- △ Do not use the equipment in rain or in a damp environment to avoid short-circuit danger

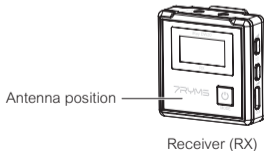
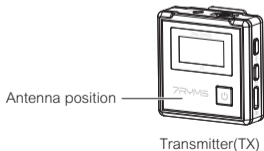

## Packing List

1. Transmitter(TX)
2. Receiver(RX)
3. 3.5mm TRS Mic Audio Input Cable
4. Wind Muff
5. 3.5mm TRS-TRS Audio Cable
6. 3.5mm TRS-TRRS Audio Cable
7. 3 in 1 Charging/Output Cable  
(The orange cable can be used for charging and digital output, the black cable can only be used for charging )
8. Carry Case
9. User Manual
10. Warranty Card



①



②



③



④



⑤



⑥



⑦



⑧



⑨



⑩

### Purchase Options:

iRay DW20 (A)

①x2+②+③x2+④x2+⑤+⑥+⑦+⑧+⑨+⑩

iRay DW20 (B)

①+②+③+④+⑤+⑥+⑦+⑧+⑨+⑩

### Transmitter(TX)

#### Components:

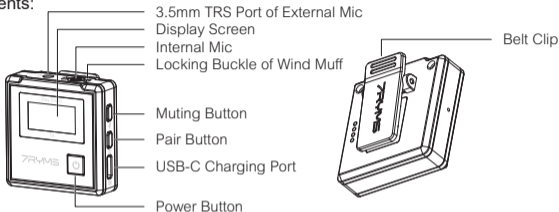

#### Function Introduction:

1. 3.5mm TRS Port of External Mic: Insert the 3.5mm TRS Mic Audio Input Cable, and you can use the external lavalier microphone for recording. At this time, the internal microphone of the device is turned off automatically
2. Power Button: Long press for On/Off

 Long press the power button for 10 seconds to reset it when the transmitter is in crashes or unable to turn on

3. Muting Button: Long press to switch between normal recording and mute
4. Pair Button: Long press for pairing with the receiver
5. USB-C Charging Port: Connect the transmitter with the power through 3 in 1 charging/output cable to charge

## Screen Display:

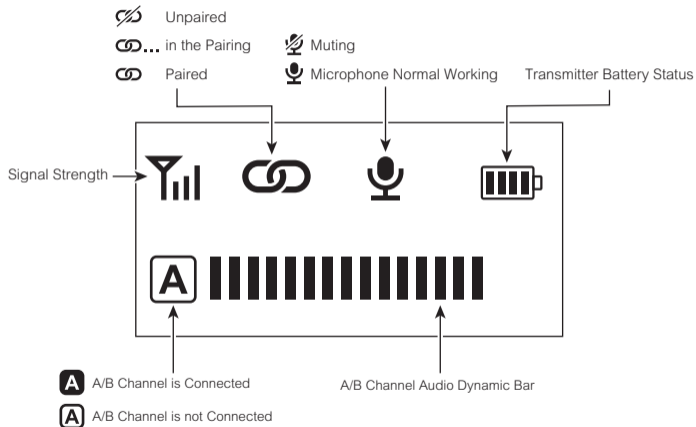

## Receiver(RX)

Components:

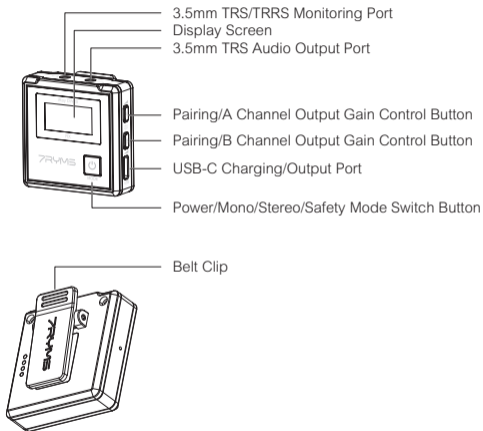



## Function Introduction:

1. 3.5mm TRS/TRRS Monitoring Port:  
Plug in 3.5mm TRS/TRRS headphones to monitor; When monitoring in Stereo mode, A is the left channel and B is the right channel
2. 3.5mm TRS Audio Output Port:  
Output a mixed audio track in Mono mode; Output two independent audio tracks in Stereo mode;  
Output two mono audio in Safety mode: One is normal audio, and the other is safe audio reduced by -6dB on the basis of normal audio
3. Pairing&A/B Channel Output Gain Control Button:  
Long press the A/B pairing button synchronously to make the receiver enter the pairing state;  
Short press to cyclically adjust the A/B channel output gain
4. USB-C Charging/Output Port:  
Connect the receiver and the corresponding device through the 3-in-1 charging/output cable for charging or digital output
5. Power/Mono/Stereo/Safety Mode Switch Button:  
Long press for On/Off; Short press for Mono/Stereo/Safety mode switch; It can not realize STEREO function when in single-channel and safety mode



Long press the power button for 10 seconds to reset it when the receiver is in crashes or unable to turn on

## Screen Display:

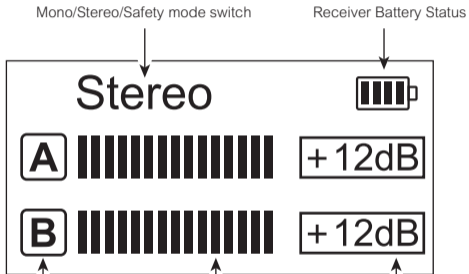

**A** A/B channel is connected      A/B Channel Audio Dynamic Bar      Output Volume

**A** A/B channel is not connected

## Installation and Usage

**Pairing Method**(All have been paired by default. If you need to re-pair, please follow the instruction)

Firstly, turn on the receiver and transmitter; secondly, long press the A/B pairing button of the receiver synchronously to make it enter the pairing state; and press the pair buttons of the transmitters for 3 seconds to make them enter the pairing state. The first paired transmitter is channel A (left channel), and the second one is channel B (right channel)

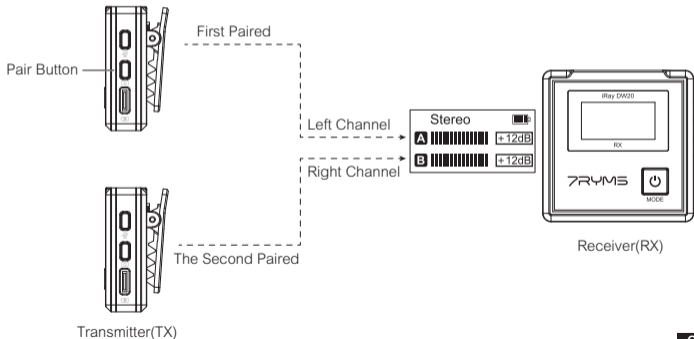

## Installation Method:

### Transmitter(TX)

Choose internal/external mic according to personal needs

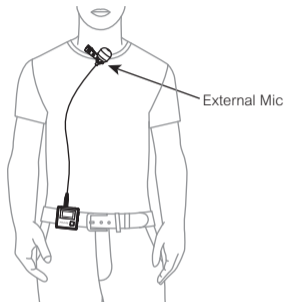
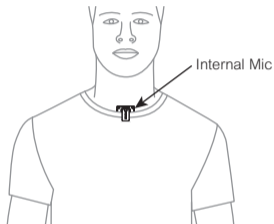

1. For better concealment during use, it is recommended that the belt clip is fixed on the outside for use
2. When the external microphone is working, the internal microphone will be automatically turned off

When using the internal mic, install the wind muff according to personal needs; Insert the wind muff into the locking buckle, and then tighten it clockwise

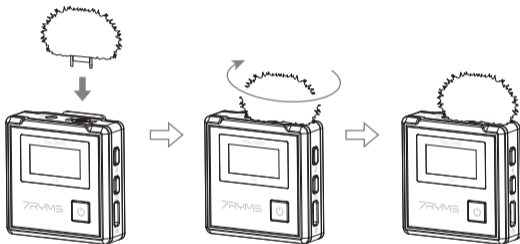

## Receiver(RX)

### 1.Work with Camera

Fix the receiver through the belt clip to the camera's cold shoe mount; Connect the receiver with camera through the 3.5mm TRS-TRS audio cable; Choose whether to monitor according to personal needs

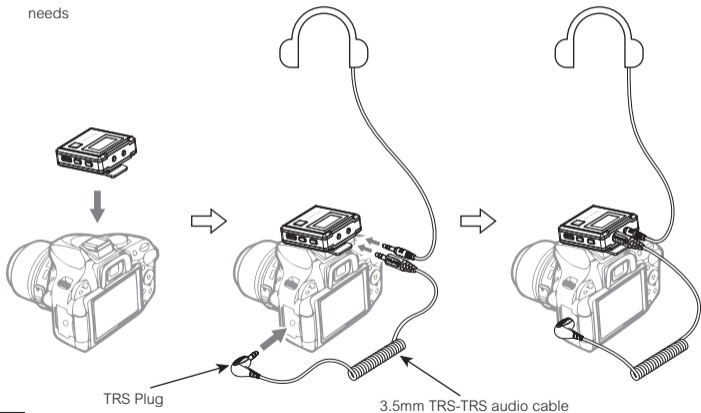

## 2.Work with Smartphone/Computer

Connect the receiver with smartphone/computer through the 3.5mm TRS-TRRS audio cable and related audio adapter cables; Choose whether to monitor according to personal needs(Please purchase related audio adapter cables by yourself)

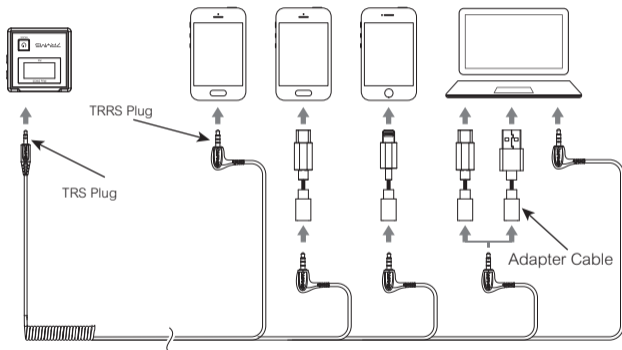

## Specifications

### Transmitter(TX)

Transmission Type	2.4GHz
Antenna	Ceramic Antenna
Transmitting Power	+10dBm
Sensitivity	-32dB±2dB
Polar Pattern	Omnidirectional
Frequency Response	80Hz ~ 20kHz
S/N	70dB SPL(A-weighted,as per IEC651)
Equivalent Noise	24dB SPL(A-weighted,as per IEC651)
Maximum SPL	110dB SPL(@ 1% THD)
Dynamic Range	86dB SPL(A-weighted,as per IEC651)
Sound Delay	<20ms
External Mic Input Port	3.5mm TRS
Battery	Li-ion Battery 230mAh 3.7V
Battery Life	10 Hours
Net Weight	28g
Dimension	45 x 45 x 22mm
Working Temperature	0°C ~ 50°C
Storage Temperature	-20°C ~ +60°C



## Receiver(RX)

Transmission Type	2.4GHz
Antenna	Ceramic Antenna
Transmitting Power	+10dBm
S/N	70dB SPL(A-weighted,as per IEC651)
Equivalent Noise	24dB SPL(A-weighted,as per IEC651)
Dynamic Range	86dB SPL(A-weighted,as per IEC651)
Sound Delay	<20ms
Output Gain Adjustment	-6dB ~ +12dB
Analog Output	3.5mm TRS
Digital Output	USB-C / 48kHz 16bits
Digital Output	3.5mm TRS/TRRS
Battery	Li-ion Battery 230mAh 3.7V
Battery Life	9 Hours
Net Weight	28g
Dimension	45 x 45 x 22mm
Working Temperature	0 C ~ 50 C
Storage Temperature	-20 C ~ +60 C



Website: [7ryms.com](http://7ryms.com)

Facebook: 7RYMS

Instagram: 7ryms\_official

YouTube: 7RYMS

The 7RYMS LOGO is a trademark which is registered and owned by Errun Electronic Technology Co., Ltd

# 7RYMS 七语



## iRay DW20

2.4G双通道无线麦克风

### 使用说明书



## 前言

感谢您购买七语iRay DW20

## 产品主要功能

- 2.4G双通道无线麦克风，全球通用频段
- 48kHz/16bit录音，智能降噪
- 数字&模拟双输出模式，通用于手机、电脑、相机
- 单声道/立体声/安全音轨模式，多音频模式输出选择
- 可视化电量及音频动态显示条
- 前置放大，10级增益可调
- 实时监听及静音功能
- 内置和外置MIC两种输入方式
- <20ms低音频延迟，100m稳定传输距离（空旷环境）
- 多功能背夹设计，小巧精悍

## 注意事项

- △由于2.4G无线特性，使用时尽量保持面对面，避免背对的情况，否则容易产生断点，属正常现象
- △使用时避免任何物体遮挡天线位置，以免信号不良
- △单通道及安全音轨模式下，立体声（STEREO）功能无法实现
- △本产品属于高精密仪器类产品，请避免使用时掉落、碰撞或重击
- △请勿将本设备放置在热源或干扰源附近使用，如散热器、烤箱或其它无线设备旁边
- △如拾音距离较近或于户外使用时，请套上麦克风防风毛，防止声音爆裂或降低风噪
- △不要在雨中或潮湿的环境中使用该设备，否则会有短路的危险



## 包装清单

1. 发射器 (TX)
2. 接收器 (RX)
3. 3.5mm TRS麦克风输入线
4. 防风毛
5. 3.5mm TRS-TRS音频连接线
6. 3.5mm TRS-TRRS音频连接线
7. 三合一充电/输出线  
(其中橙色线具备充电和数字输出功能,  
另外两条黑色线只具备充电功能)
8. 便携包
9. 说明书
10. 保修卡



①



②



③



④



⑤

⑥



⑦



⑧



⑨



⑩

搭配选择:

iRay DW20 (A)

①x2+②+③x2+④x2+⑤+⑥+⑦+⑧+⑨+⑩

iRay DW20 (B)

①+②+③+④+⑤+⑥+⑦+⑧+⑨+⑩

## 发射器 (TX)

### 部件介绍:



### 功能介绍:

1. 3.5mm TRS外置麦克风插孔: 插入3.5mm TRS麦克风输入线, 即可使用外置领夹麦克风录音, 此时本机的内置麦克风自动关闭
2. 电源按键: 长按开机/关机

 如出现死机/无法开机等异常现象, 长按电源键10秒, 即可重置复位

3. 静音按键: 长按切换静音
4. 配对按键: 长按与接收器进行配对
5. USB-C充电插口: 通过三合一充电/输出线连接发射器与电源进行充电



## 屏幕显示:

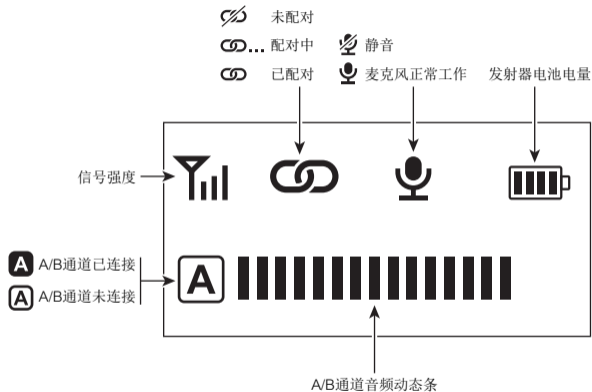

## 接收器 (RX)

### 部件介绍:

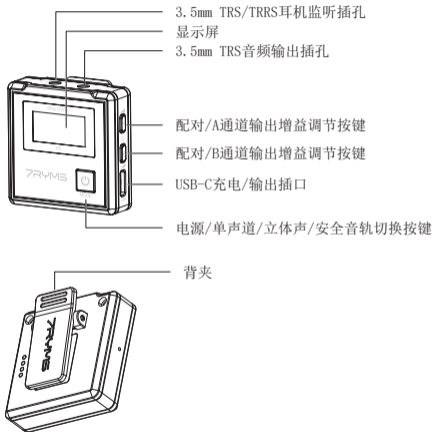

## 功能介绍:

1. 3.5mm TRS/TRRS耳机监听插孔:  
插入3.5mm TRS/TRRS耳机即可监听; 立体声模式下,A为左声道,B为右声道
2. 3.5mm TRS音频输出插孔:  
单声道模式下,输出两路通道合并的音轨; 立体声模式下,输出A和B两路独立音轨; 安全音轨模式下,输出两路单声道音频,一路为正常音频,一路为正常音频降低-6dB后的安全音频
3. 配对&A/B通道输出增益调节按键:  
同时长按A/B配对按键进入配对状态; 短按可循环调节A/B通道输出增益
4. USB-C充电/输出插口:  
通过三合一充电/输出线连接接收器和相应的设备进行充电/数字输出
5. 电源/单声道/立体声/安全音轨切换按键:  
长按开机/关机; 短按进行单声道、立体声与安全音轨模式切换; 单通道及安全音轨模式下,立体声(STEREO)功能无法实现

 如出现死机/无法开机等异常现象, 长按电源键10秒, 即可重置复位

## 屏幕显示:

Mono: 单声道  
Stereo: 立体声  
Safety: 安全音轨模式

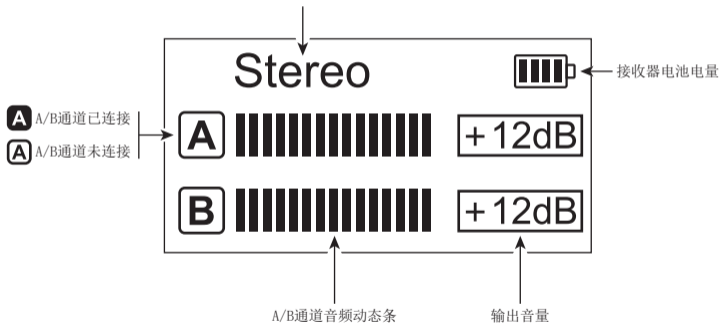

## 配对方法（出厂已默认配对，如遇特殊情况需重新配对可参考以下配对方法）

将接收器和发射器开机后，同时长按接收器A/B配对按键进入配对状态，再长按发射器的配对键3秒进入配对状态。先配对成功的发射器为A通道（左声道），后配对成功的发射器为B通道（右声道）

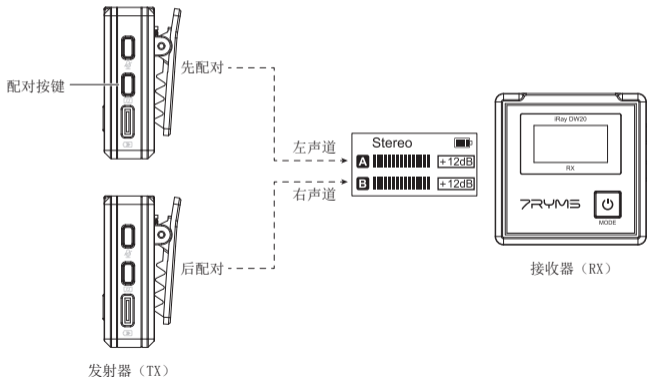

## 安装方法:

### 发射器 (TX)

根据个人需求选择使用内置/外置麦克风

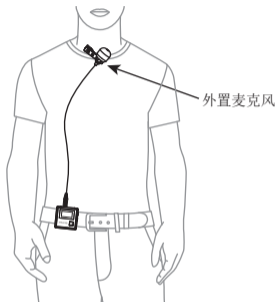
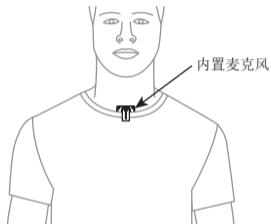

- 1. 当使用内置麦克风时, 为了更好的隐蔽性, 建议将背夹朝外固定使用
- 2. 当使用外置麦克风时, 内置麦克风会自动关闭

当使用内置麦克风时，根据个人需求安装防风毛；将防风毛插入防风毛卡扣，再顺时针拧紧固定

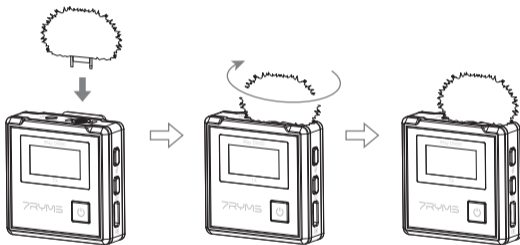

## 接收器 (RX)

### 1. 搭配相机

将接收器的背夹夹到相机的冷靴座上；通过3.5mm TRS-TRS音频连接线连接接收器和相机；根据个人需求选择是否进行监听

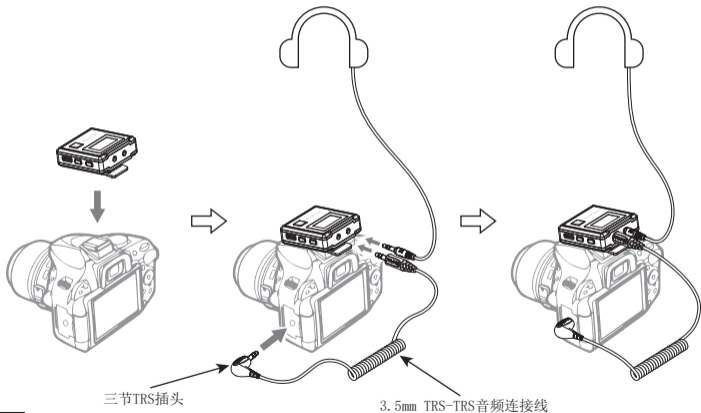



## 2. 搭配手机/电脑

通过3.5mm TRS-TRRS音频连接线和相关音频转接线连接接收器和手机/电脑；根据个人需求选择是否进行监听  
(请自行购买相关音频转接线)

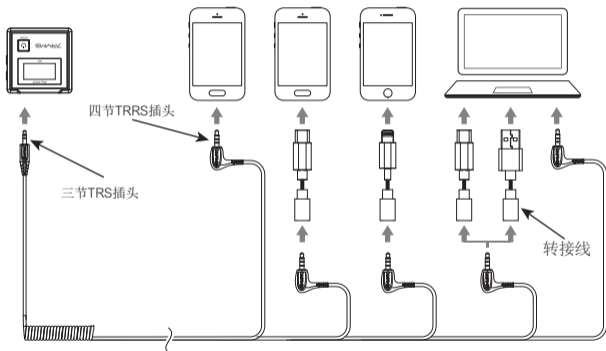

## 发射器 (TX)

无线类型	2.4GHz
天线	陶瓷天线
发射功率	+10dBm
麦克风灵敏度	-32dB $\pm$ 2dB
麦克风指向性	全指向
麦克风频率响应	80Hz ~ 20kHz
系统信噪比	70dB SPL (A-weighted, as per IEC651)
系统等效噪声	24dB SPL (A-weighted, as per IEC651)
最大声压级	110dB SPL (@ 1% THD)
动态范围	86dB SPL (A-weighted, as per IEC651)
声音延迟	<20ms
外置输入接口	3.5mm TRS
电池	锂聚合物 230mAh 3.7V
续航时间	10小时
净重	28g
尺寸	45 x 45 x 22mm
工作温度	0°C ~ 50°C
存储温度	-20°C ~ +60°C

## 接收器 (RX)

无线类型	2.4GHz
天线	陶瓷天线
发射功率	+10dBm
系统信噪比	70dB SPL(A-weighted, as per IEC651)
系统等效噪声	24dB SPL(A-weighted, as per IEC651)
动态范围	86dB SPL(A-weighted, as per IEC651)
声音延迟	<20ms
输出调节范围	-6dB ~ +12dB
模拟输出	3.5mm TRS
数字输出	USB-C / 48kHz 16bits
监听接口	3.5mm TRS/TRRS
电池	锂聚合物 230mAh 3.7V
续航时间	9小时
净重	28g
尺寸	45 x 45 x 22mm
工作温度	0°C ~ 50°C
存储温度	-20°C ~ +60°C



扫二维码关注  
七语官方公众号



7RYMS七语麦克风



7RYMS七语



七语影音旗舰店



7RYMS七语

邮箱: [support@7ryms.com](mailto:support@7ryms.com)

电话: 400-8303-981

网址: [www.7ryms.com](http://www.7ryms.com)

版权及七语商标归尔润电子科技有限公司所有